

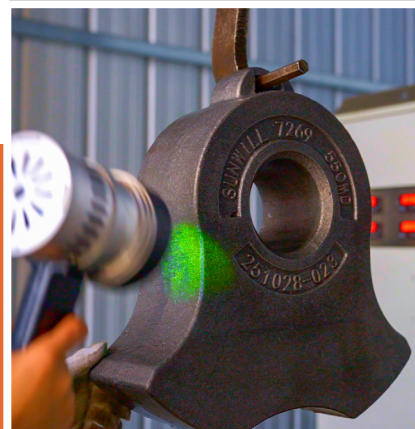

QUALITY is the FIRST of all

Every piece of products will be inspected and guaranteed in good quality.

- ✓ Dimension Inspection (100% at key area)
- ✓ Chemical Analysis (After melting)
- ✓ Destructive Testing (If requested)
- ✓ Hardness Testing (PER heat-treatment batch)
- ✓ MT Testing (Every piece for certain products)
- ✓ UT Testing (Every piece)
- ✓ Finishing, Cast numbers (Every piece)
- ✓ Destructive Testing (Frequently)

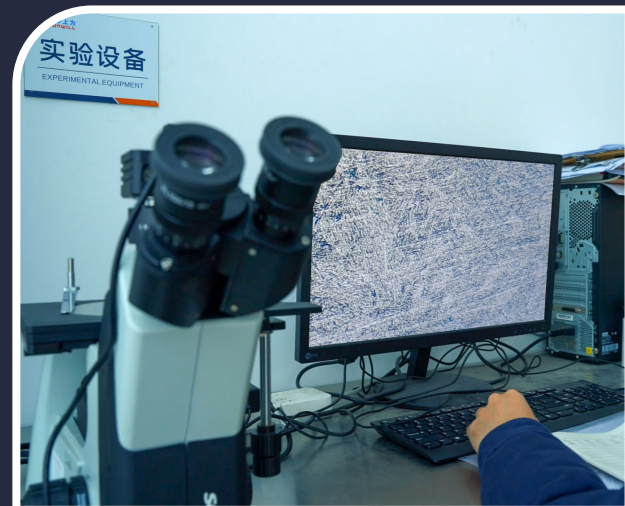

Phone Number:

+86-731-8299 0186
+86-157 7313 2058

Email and web:

www.sunwillmachinery.com
info@sunwillmachinery.com

Our office:

No. 2748 Jinyang Avenue,
Liyang Economic Development Zone,
Liyang, Changsha, Hunan, China
(15KM from Changsha International Airport)



Recycling / Demolition

Brief Directory:

- Page 2...Know-how DHT hammer
- Page 3...Available patterns
- Page 4...Other wear parts
- Page 5...How can we ensure good quality

— One step solution
**BETTER PARTS
FOR
METAL RECYCLING**



CORE ANTI WEAR TECHNOLOGIES

DHT HAMMER Differential Heat treatment

Our Tuff Alloy Steel Hammer is specially heat-treated to obtain high hardness at wear section, while lower hardness plus high strength at bore area



TYPICAL MATERIALS:

- Martensitic/ Low Alloy steel
- Manganese steel

LONGER LIFE SOLUTION:

- Martensitic DHT (up to 100% longer)

Pin-eye area 330-400 HB
to make installation area softer
to protect hammer pins

Working head area
530-580 HB
to better balance hardness
and wear resistance
to extend life span,
up to 100% increased

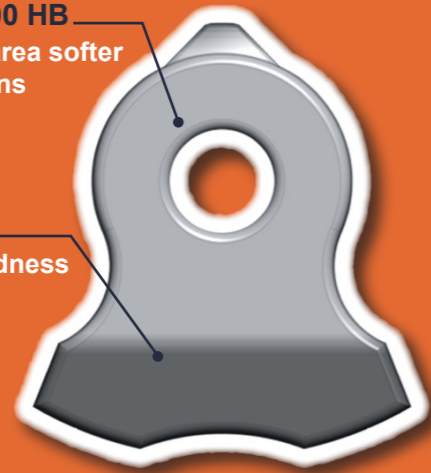

Section	Material Code	Chemical	Hardness Brinell	Charpy Impact
Hammer bore	TF55D	40CrNiMo modified	330-400	> 10 (RT °C, AKV, J) > 8 (-40 °C, AKV, J)
Hammer head	TF55D	40CrNiMo modified	530-580	> 6 (RT °C, AKV, J) > 4 (-40 °C, AKV, J)

- More Than 100+ Patterns available
- Unit weight ranged from 80 kg to 400 kg, covering model # 6090, 6990, 7090, 8090, 98104 etc.
- Customized material & design available

Make adjustments on hammer shape and extend effective shredding radius, which will significantly improve shredding efficiency and increase service life.

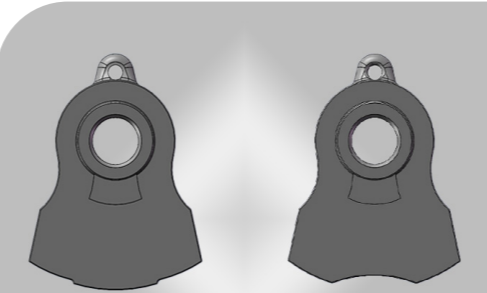

Working end changed from protruding to concave to prevent blockage.



OTHER WEAR PARTS

Shredder cap
Material Options:
• Mn steel
• Alloy steel HB500



Grid
Material:
• Moly rich Mn steel

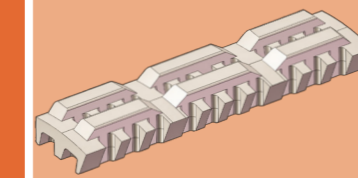

Spacer for hammermill,
Grinder for vertical mill
Material Options:
• Mn steel
• Alloy steel HB500

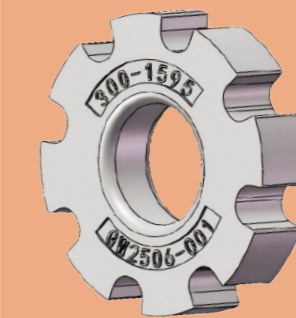

Double feeder roll tooth,
DFR tooth
Material:
• DHT with HB500-550

